

# affordable housing





## SatiQ Concrete Manufacturer

Affordable housing solutions can be achieved through innovative construction methods that prioritize rapid, sustainable, and durable building practices. One approach is to utilize confined masonry constructed with performance-based binder systems.

A key benefit of this approach is the potential to significantly reduce carbon footprint. Furthermore, the materials used can be derived from waste sources, making this method waste-agnostic.

The advantages of this construction method include:

- Rapid construction timelines
- Sustainable building practices
  - Durable structures
- Reduced environmental impact

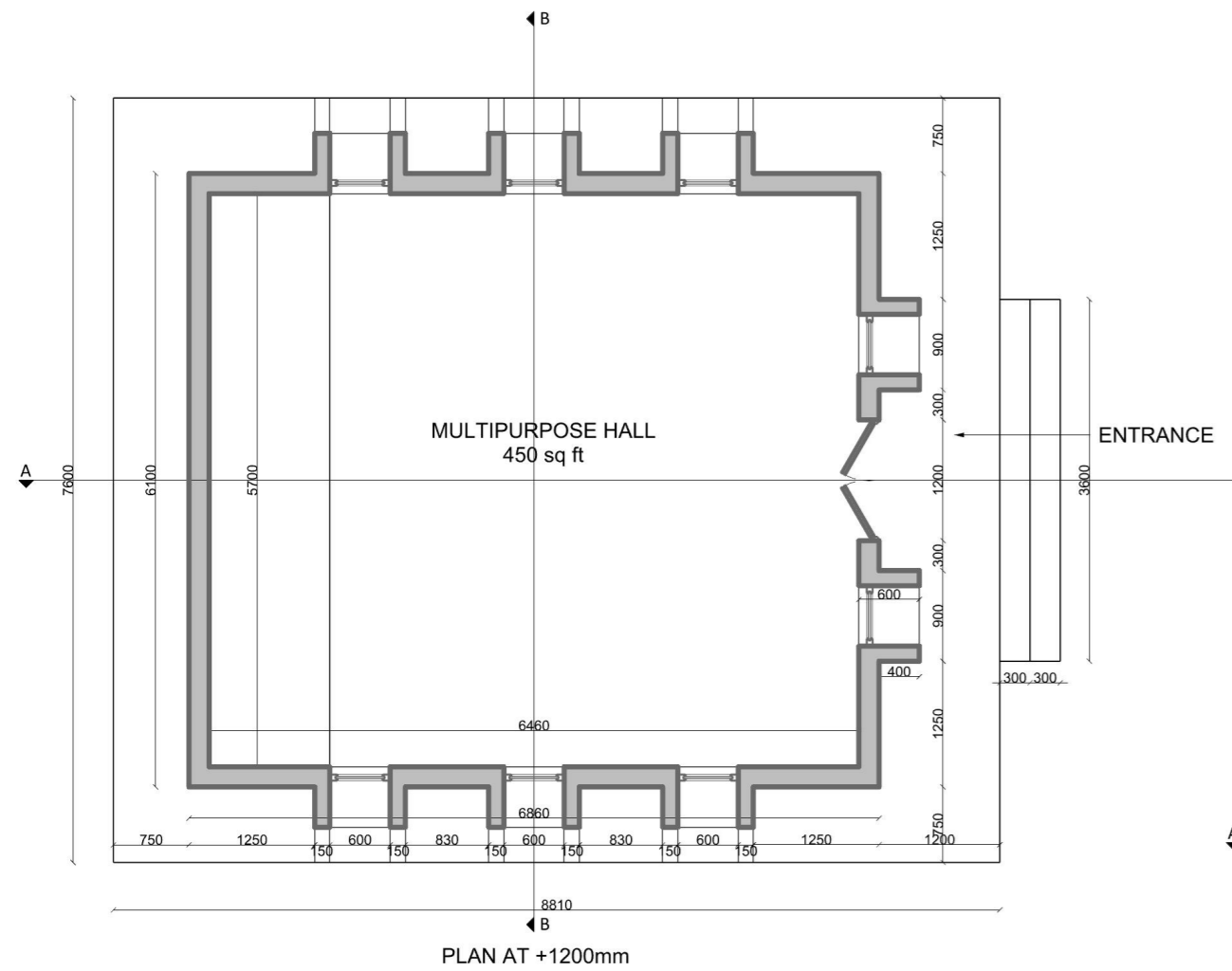





## GET IN TOUCH

+91 96782 38046

[connect@scmconcrete.com](mailto:connect@scmconcrete.com)

<https://www.scmconcrete.com/>

